



For safety reasons, we kindly ask you to read this installation and user guide before fitting and using the product. The installation shall be carried out by licensed electrician. Please consult with a qualified electrician to confirm appropriate compliant installation location.

Please check contents of package for any damage occurred during shipment. If damage has occurred, please contact reseller or supplier immediately for warranty claim. Once it is installed, supplier and resellers are not liable any damage.

Handling Tips:

Never place the shaving cabinet on hard surface and always lift it with two people or more.

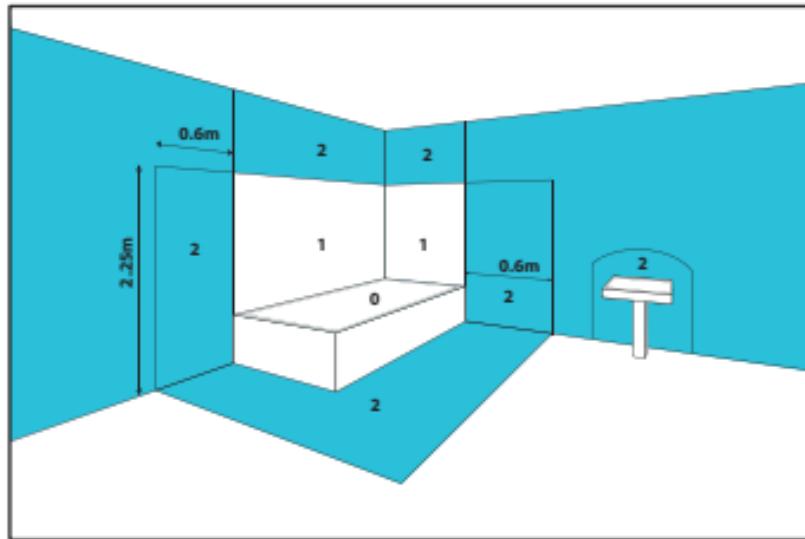
Zone Diagram**General information and maintenance**

1. Use appropriate wall fixing for your wall type
2. The mirror is suitable for zone 2 or higher. Refer to the zone diagram.
3. Switch off the electrical supply at the mains before the installation and maintenance.
4. Do not leave the mirror on for prolonged period.
5. For cleaning and maintenance, wipe the mirror surface with a few drops of methylated spirits or isopropyl alcohol

*Diagrams are not to dimension or exact product or wall, guide only.

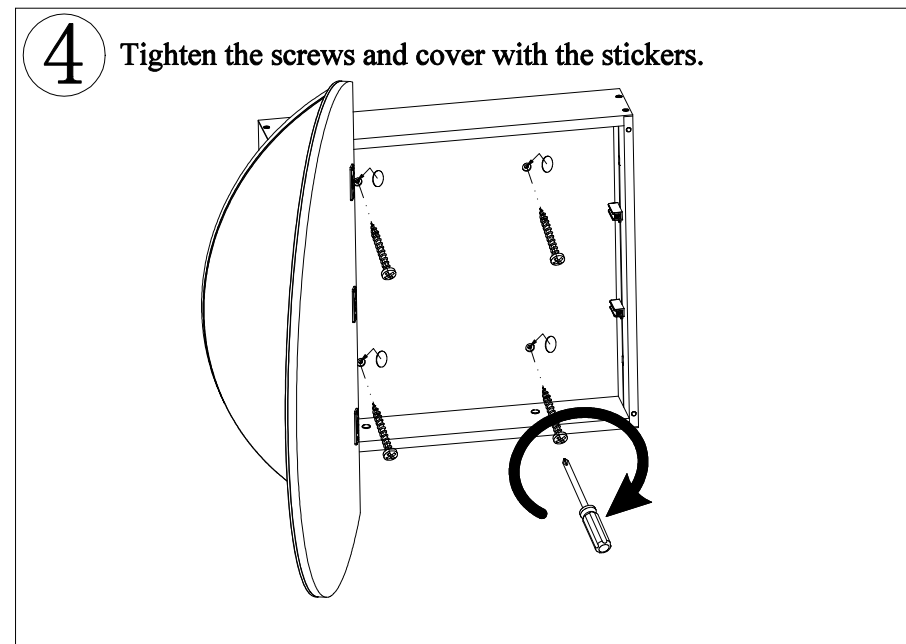
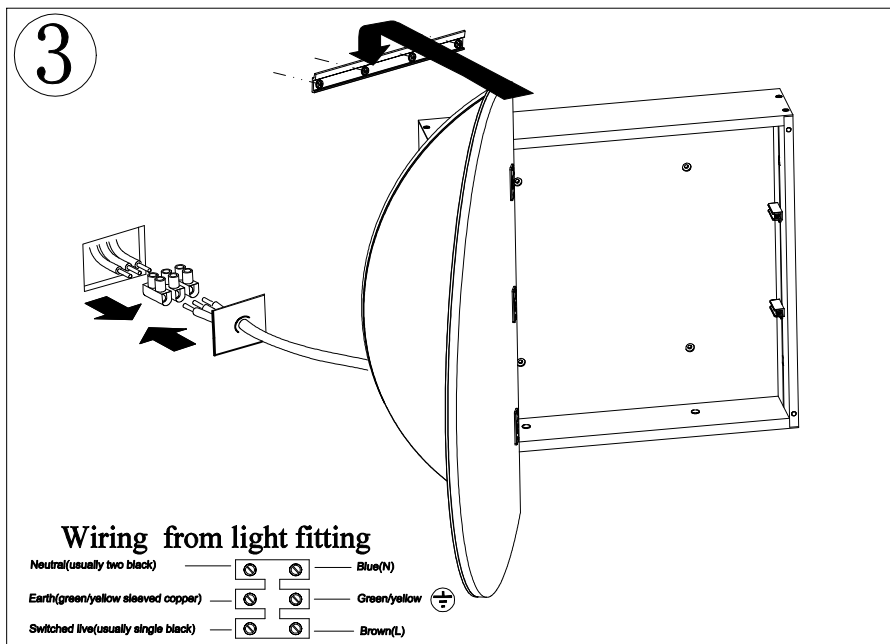
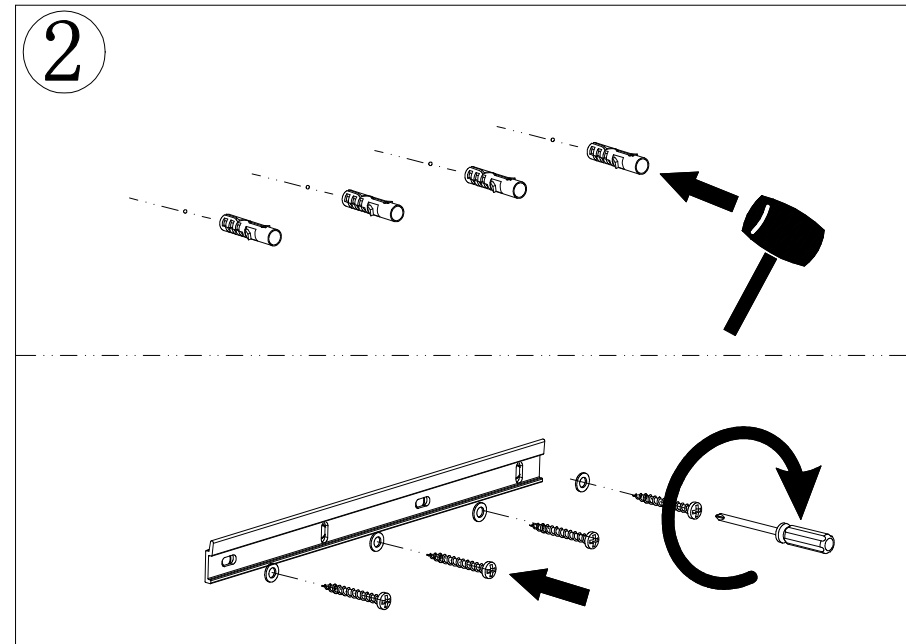
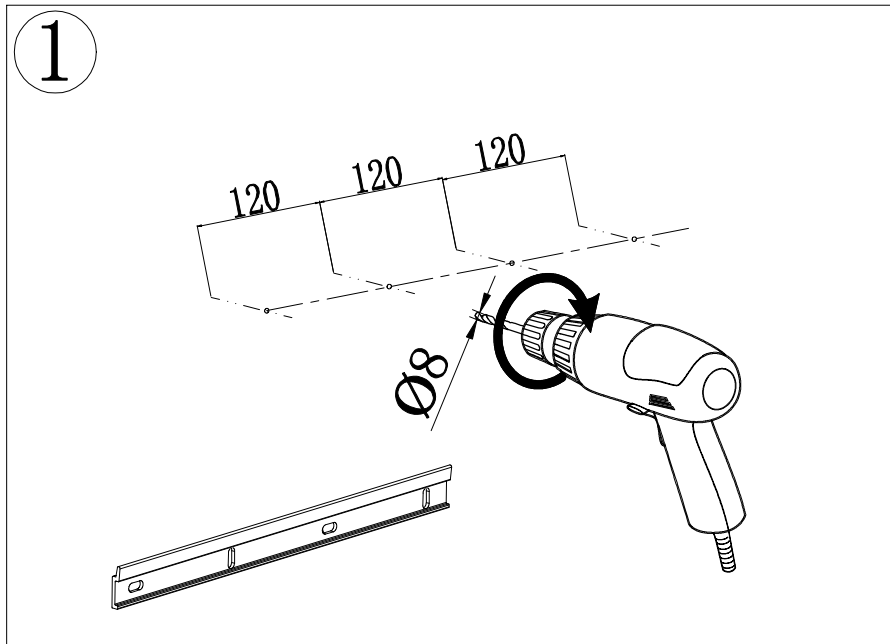

REMER

Recess mounting installation instructions.

- 1 Unplug the rubber lid and drill holes on the frame of the cabinet.

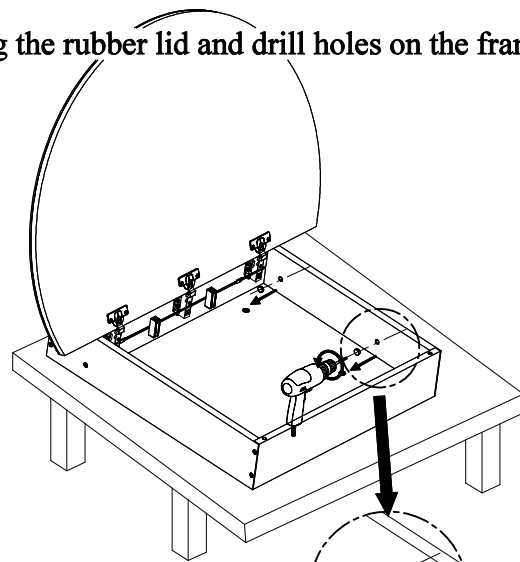

DETAIL

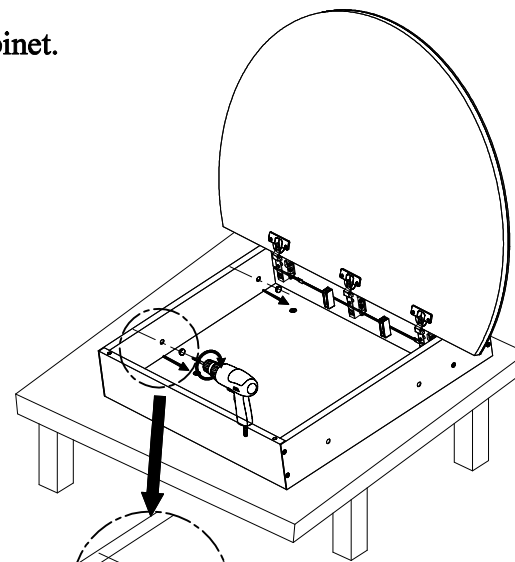

DETAIL

- 2 Wiring from light fitting.

Neutral(usually two black) — Blue(N)
 Earth(green/yellow sleeved copper) — Green/yellow(\perp)
 Switched live(usually single black) — Brown(L)

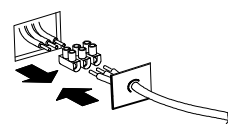

DETAIL

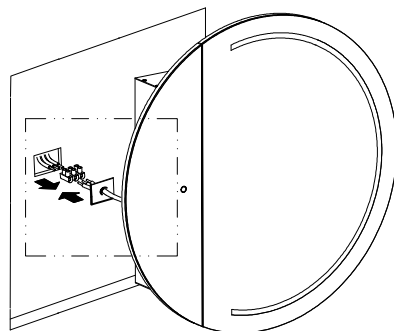

- 3 Place the cabinet in rough-in and make sure cabinet is plumb and level.

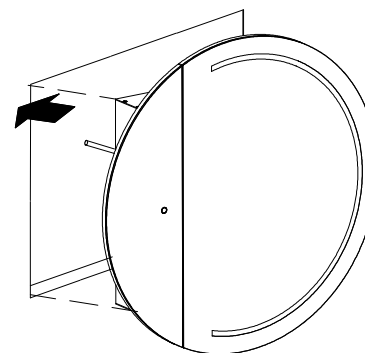

REMER

Recess mounting installation instructions.

- 4 Tighten the grub screws and cover with the rubbers.

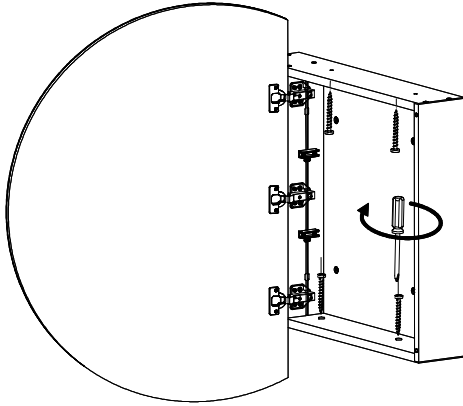

- 5 Cover the screw holes with sticker provided.

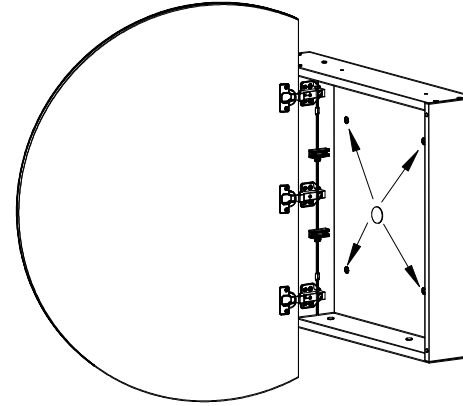

- 6 Finish the installation.

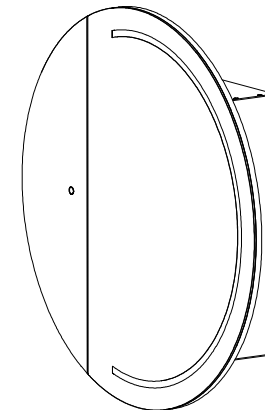
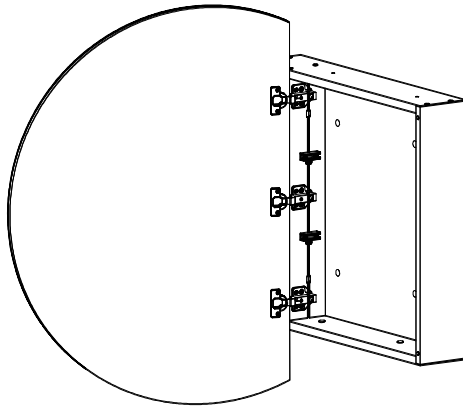

1 Loosen grub screws.

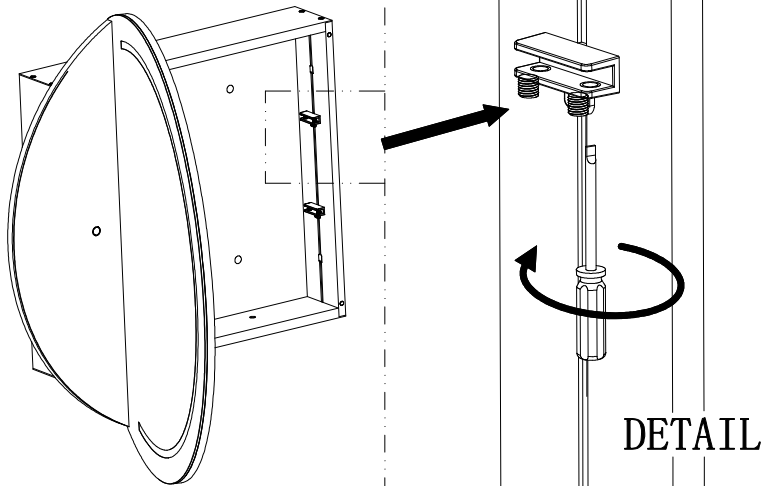

2 Insert the glass shelf between shelf holders.

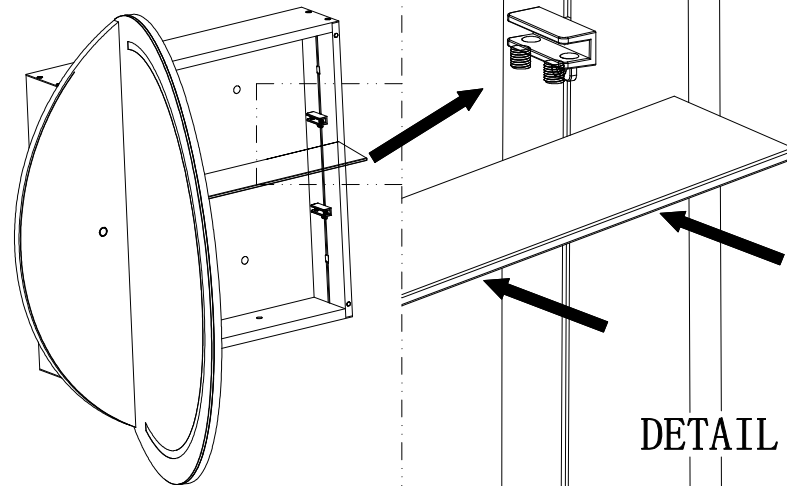

3 Tighten grub screws.

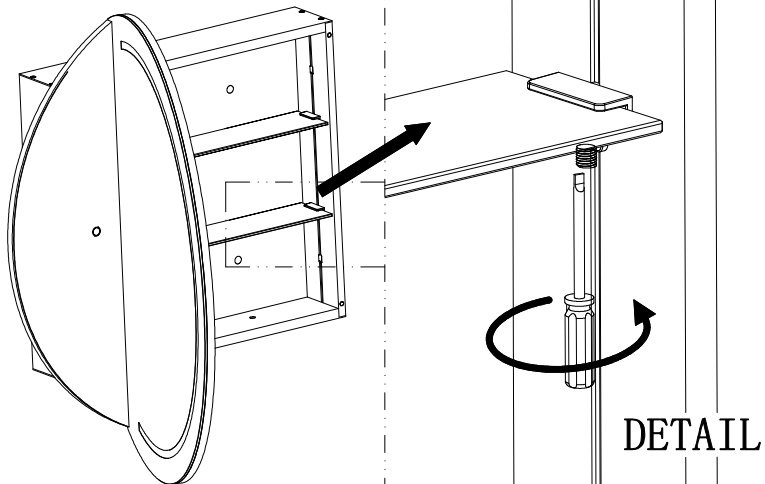

4 Loosen screws to adjust shelf to desired height and tighten it.

